

Free roaming dog estimation tools - the TALEA app

Tomislav Mikuš
Andreas Chaidousis
Anida Dinarević

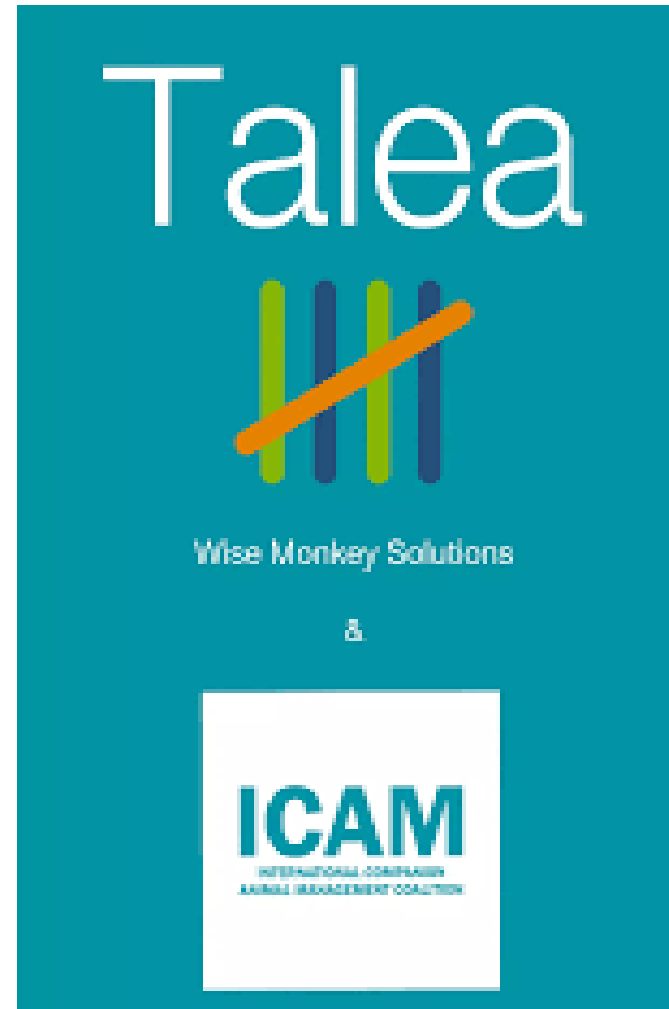

- Overall strategy

- to bridge over the gap between Academia and Policy makers in the region and to help them in the implementation of regional and international best practices in the field of Animal Welfare.

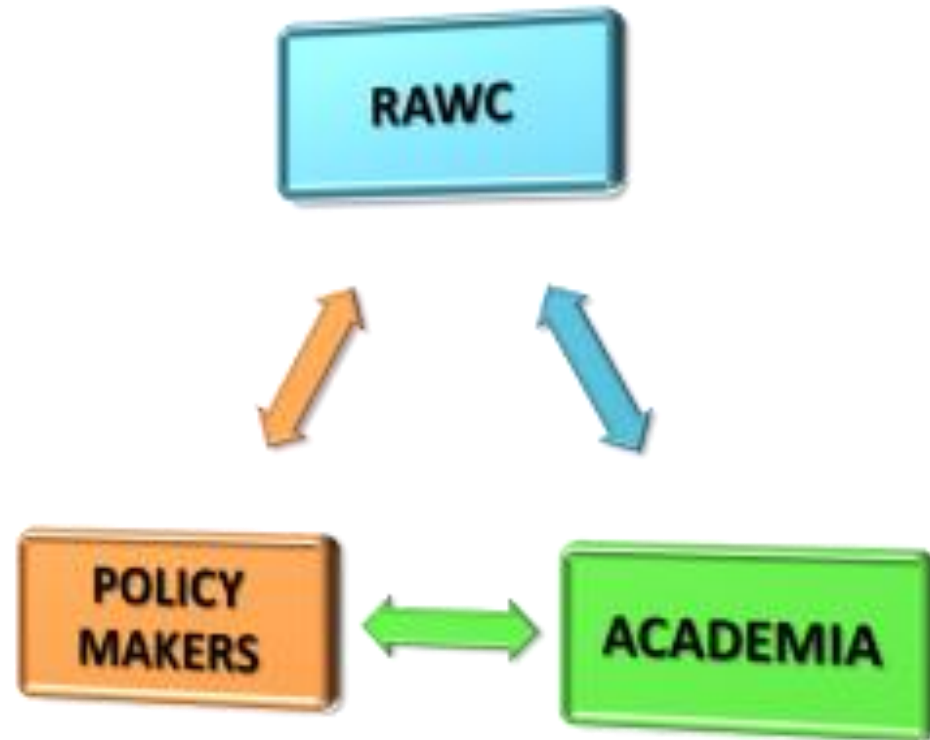

RAWC prioritize activities in the following areas

- **Training of business operators and stakeholders** (slaughter, pigs, broilers and transport) – coordination and dissemination of information and resources;
- **Experimental animals – implementation and training;**
- **Companion animals population management and dog population management** – develop a regional approach and share best practice;
- **Raising farmer awareness** and engaging with **small scale farmers** to establish an effective and targeted regional approach and to explore new business models;



Companion animals population management - DPM



- **Shelter Quality**
 - Active participation of four regional experts on Shelter Quality project activities.
- **Be his hero!**
 - Launched in 8 Countries of the region (Albania, Bosnia&Herzegovina, Croatia, Kosovo, Bulgaria, Serbia, North Macedonia and Montenegro). RAWC collaborated with OIE on translation, printing and distribution of the materials, and a little bit more.
- **Training of trainers on ICAM dog population management indicators**
 - 17 trainers trained





ICAM Coalition

- ICAM Coalition formed in 2006
 - Discuss, share and learn...
 - Humane DPM guidance
 - Initial assessment prior to planning
 - No 'one size fits all'
 - Match intervention to local dog population dynamics

8 Impacts

1. Improve dog welfare
2. Improve care provided to dogs
3. Reduce dog density/Stabilise turnover
4. Reduce risks to public health
5. Improve public perception
6. Improve rehoming centre performance
7. Reduce negative impacts of dogs on wildlife
8. Reduce negative impacts of dogs on livestock





Before Talea

- or how it can be done without a modern mobile apps, just some ordinary tools.



Before the streets...

- **Route identification:**
- **Unbiased** (randomly selected streets)
 - Should be planned by somebody who does not know anything about the abovementioned hot spots.
- **Hot spots** (route with most dogs)
 - Should be planned by somebody who knows where and when dogs are there.

Digitalisation

- After the route identification, and due to the accuracy of the each next repetition it was needed to transfer the route to the GPS tracking program.
- In our case – Google Maps

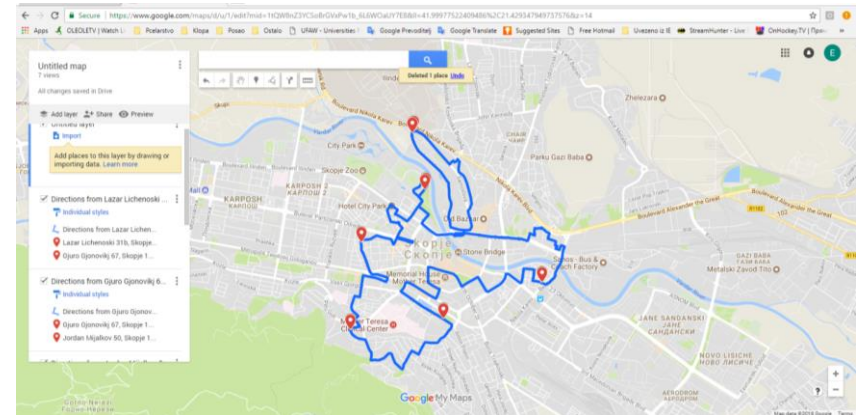
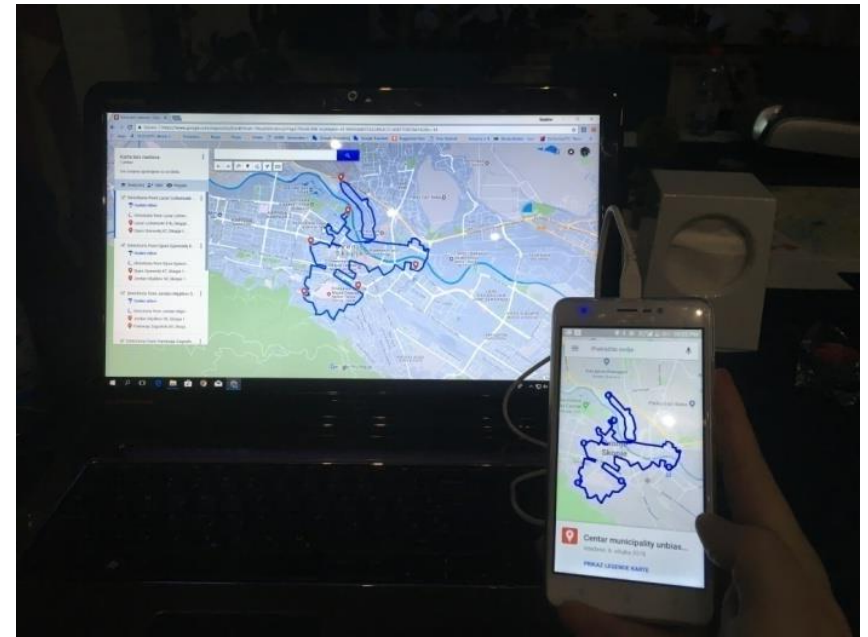

Survey

- For dog counting keep in mind that you have to go on the streets before the morning rush starts, because if you go later it will be harder to spot the dogs.
- Dogs in Skopje, being Balkan dogs, were mostly sleeping at that time.



Data processing

- After the collection, data needs to be evaluated and processed.
- In our case – **Microsoft Access form**, with preordered formulas for calculation.

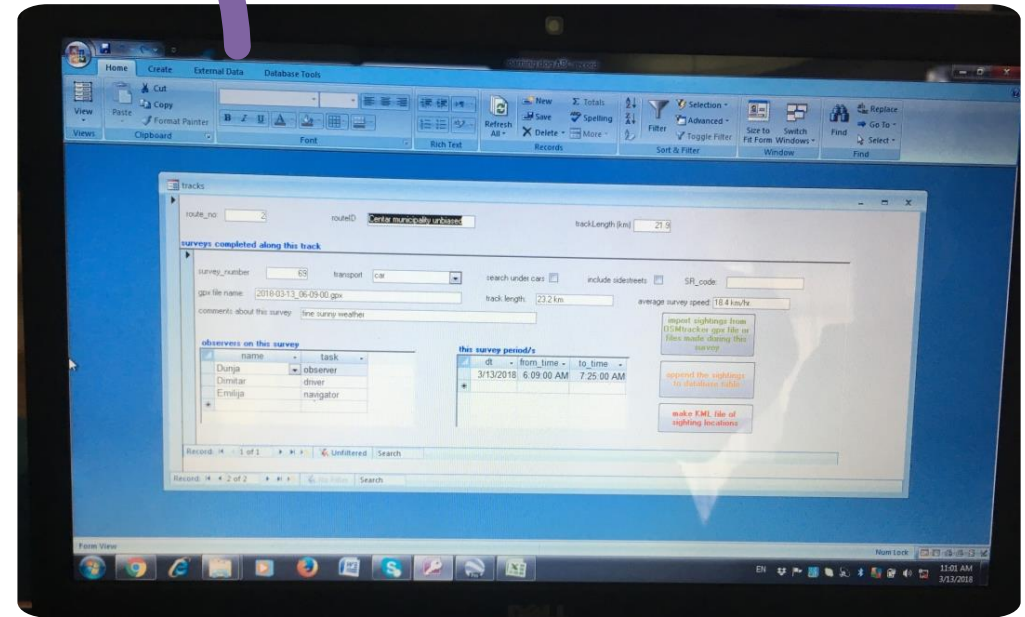

Next step – face to face interviews

KoBo Collect

Free program for
questionnaire survey.

Easy to question
development, easy to
use with a very
proactive customer
support.

Android phone – one folder



Data processing and results

- Face to face interviews gives us very good look at what is going on in specific area.
- What are the people toughs, and what mindset is on the streets.



General questions

V2 Updated D... 59% 1:59 p.m.

In the last month, have you been annoyed or troubled by a dog or dogs in your neighbourhood?

Yes

No

Over the last 12 months, do you think there has been a change in the number of roaming dogs in your community, and if so, in what direction?

Decreased

Stayed the same

General questions

59% 1:59 p.m.

V2 Updated D...

Do you or anyone in your home currently offer regular care, such as food, to a street dog that doesn't have an identifiable owner? ('regular' care means at least once per week)?

Yes

No

Do you know anyone in your neighbourhood whose dog had puppies in the last 12 months? This can include puppies born within your own household.

Ensure the respondent can answer "yes" whilst still remaining anonymous, if it is their household who had the puppies

Dog identification and health

The image displays two screenshots of a mobile survey form. The top screenshot shows a question about rabies vaccination, and the bottom screenshot shows a question about parasite medication. Both questions are for a 'Household dog (1)' and have three radio button options: 'Yes', 'No', and 'Don't know'.

V2 Updated D... 59% 1:59 p.m.

Household dog (1)

Was your dog rabies vaccinated in the last 12 months?

Yes

No

Don't know

V2 Updated D...

Household dog (1)

Has your dog been given parasite medication in the last 4 months?

Yes

No

Don't know

Do not forget – ethics!

- The data we collect, the way in which we collect or use it may cause harm
- Harms may be direct or contingent
- Immediately evident or only apparent in the future
- Graded in severity – mild/moderate/severe

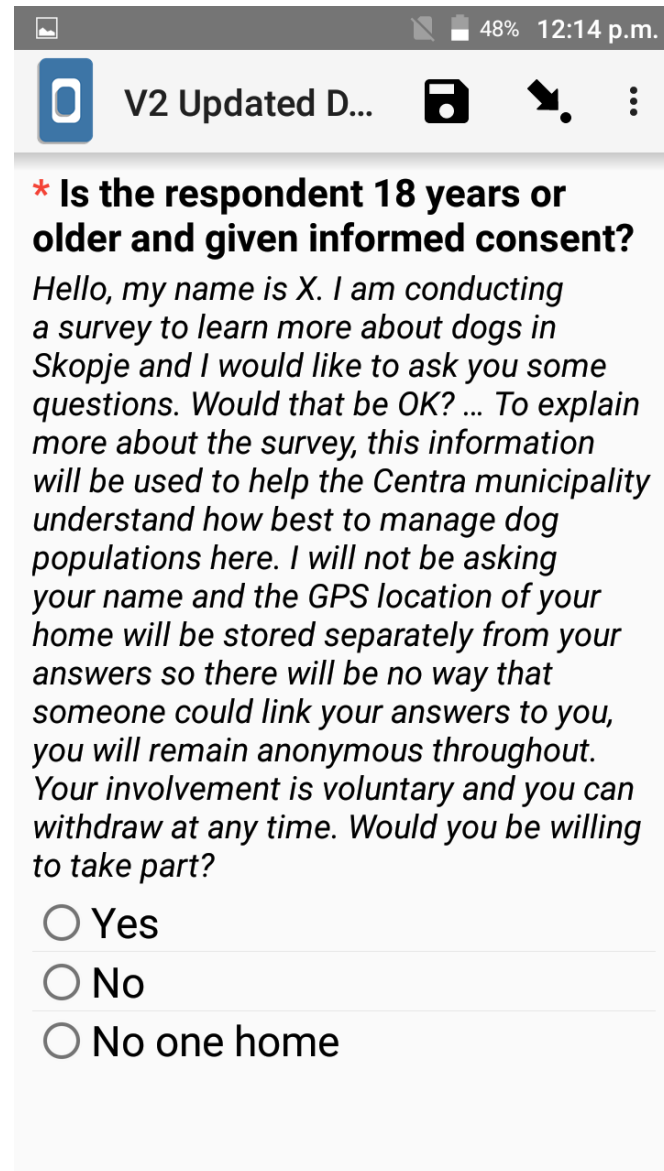

The screenshot shows a mobile application interface for a survey. At the top, the status bar displays the time as 12:14 p.m. and the battery level at 48%. Below the status bar, there is a navigation bar with a blue icon of a smartphone, the text "V2 Updated D...", and three icons: a document, a cursor, and a vertical ellipsis. The main content area features a red asterisk followed by the question: "Is the respondent 18 years or older and given informed consent?". Below the question is a paragraph of text explaining the survey's purpose and data handling. At the bottom, there are three radio button options: "Yes", "No", and "No one home".

*** Is the respondent 18 years or older and given informed consent?**

Hello, my name is X. I am conducting a survey to learn more about dogs in Skopje and I would like to ask you some questions. Would that be OK? ... To explain more about the survey, this information will be used to help the Centra municipality understand how best to manage dog populations here. I will not be asking your name and the GPS location of your home will be stored separately from your answers so there will be no way that someone could link your answers to you, you will remain anonymous throughout. Your involvement is voluntary and you can withdraw at any time. Would you be willing to take part?

Yes

No

No one home

On the field

- When entering properties, backyards or apartments, keep in mind:
- **IF IT'S WIERD – LEAVE.**





RAWC DPM training and Talea app

Andreas Chaidousis, DVM

The training of DPM trainers

- Held from 5th to 8th of July 2022 in Skopje, North Macedonia
- Conducted by Elly Hibby, PhD, an Independent Animal Welfare Consultant and Scientific Coordinator to the International Companion Animal Management (ICAM) Coalition



- The training comprised theoretical courses, practical workshops as well as E-learning modules using an online platform and TALEA.

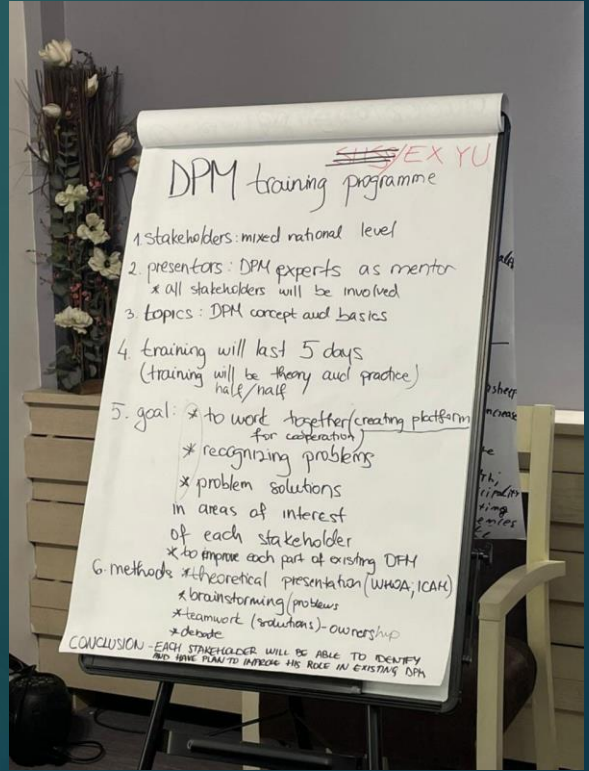
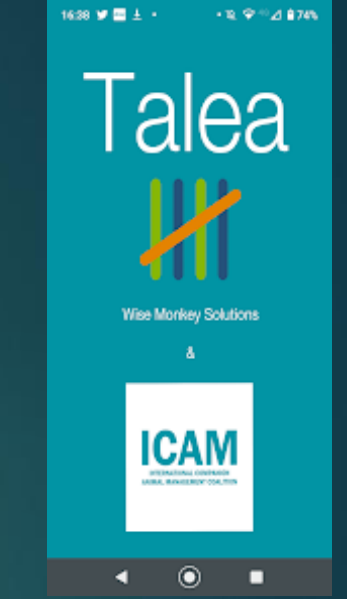
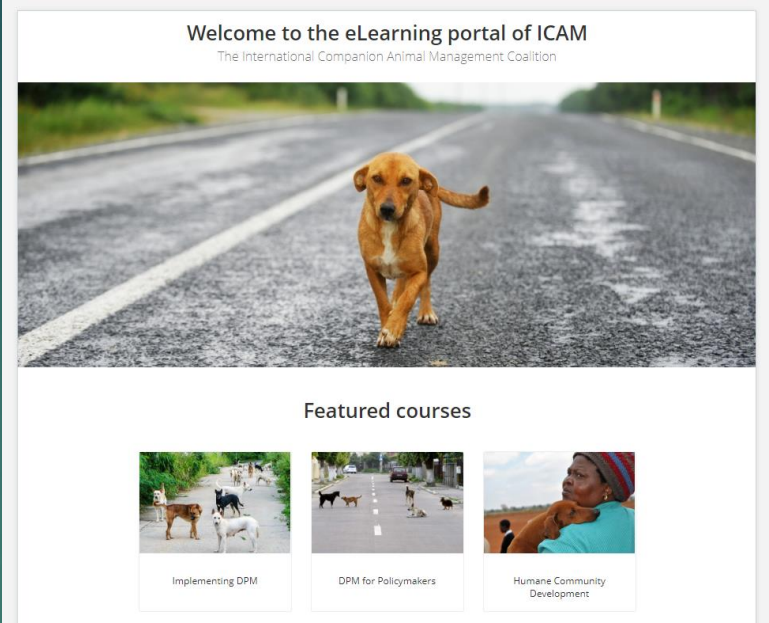

- It also included daily population monitoring on the streets and surveying the general public regarding the roaming dog problem



The Talea app



- What is it?
- Why do we do street surveys?
 - Primary assessment
 - Monitoring
 - Evaluation
- Relevance in the future – the arrival of new tools
- Species Distribution Models
- Street Dog Sim (Dr. Andrew Yoak, Dr. Kellen Calinger, Dr. Ely Hiby)

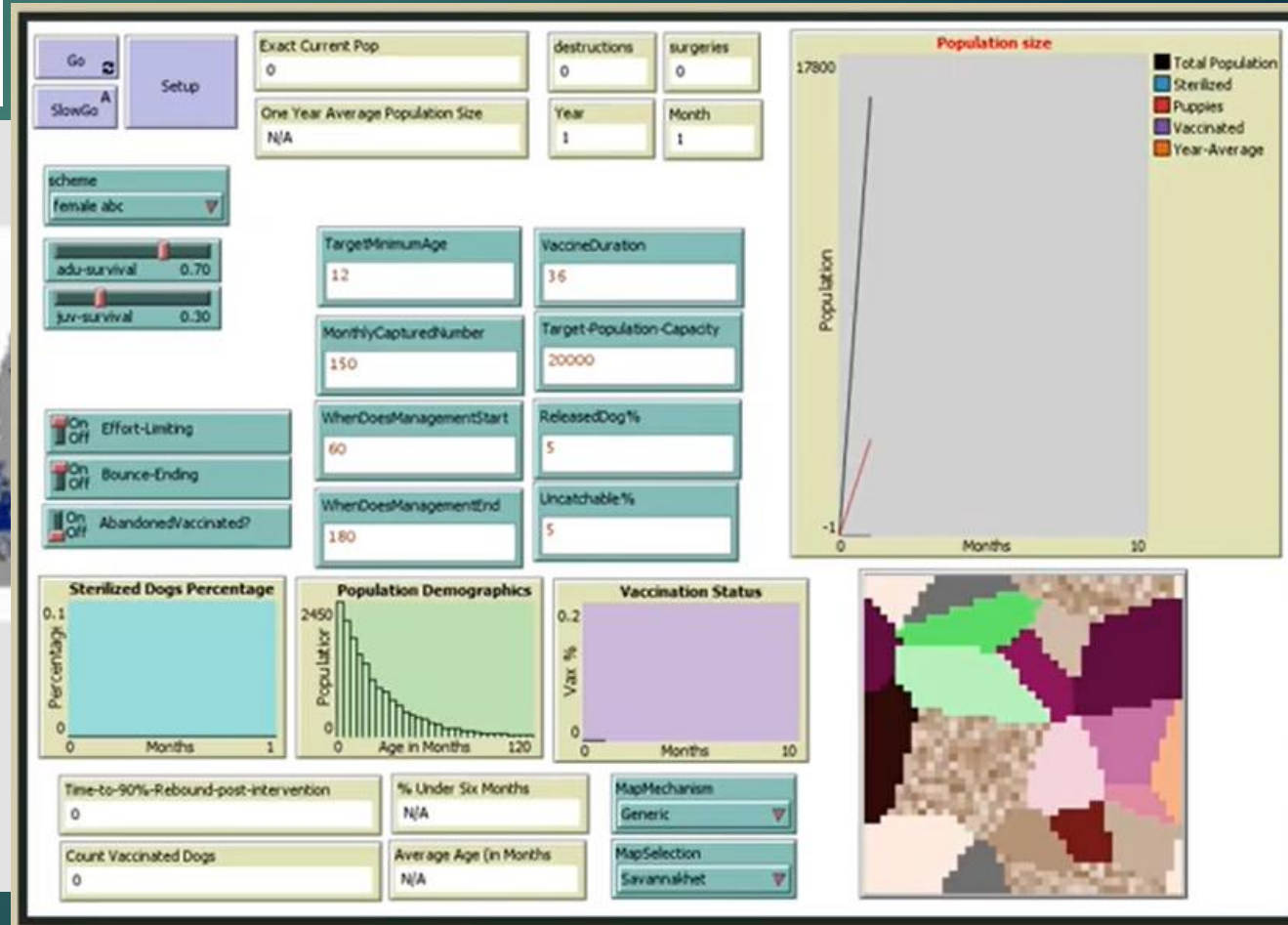

How does it work?

Talea web and app



- Flexible
 - Templates: library, amend or create
 - Sandboxes:
 - » Routes or polygons
 - » Sighting location = observer location, or indicate animal location on map



Talea web and app

- Easy
 - Icons
 - Single tap

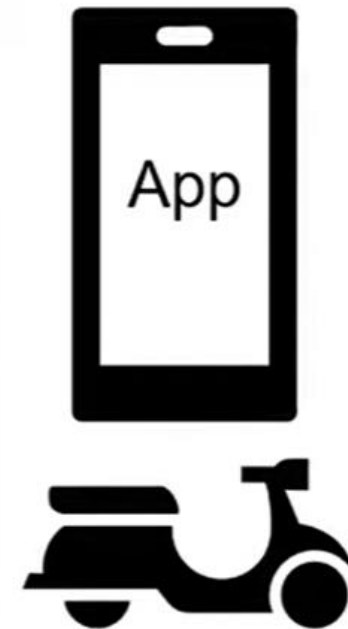
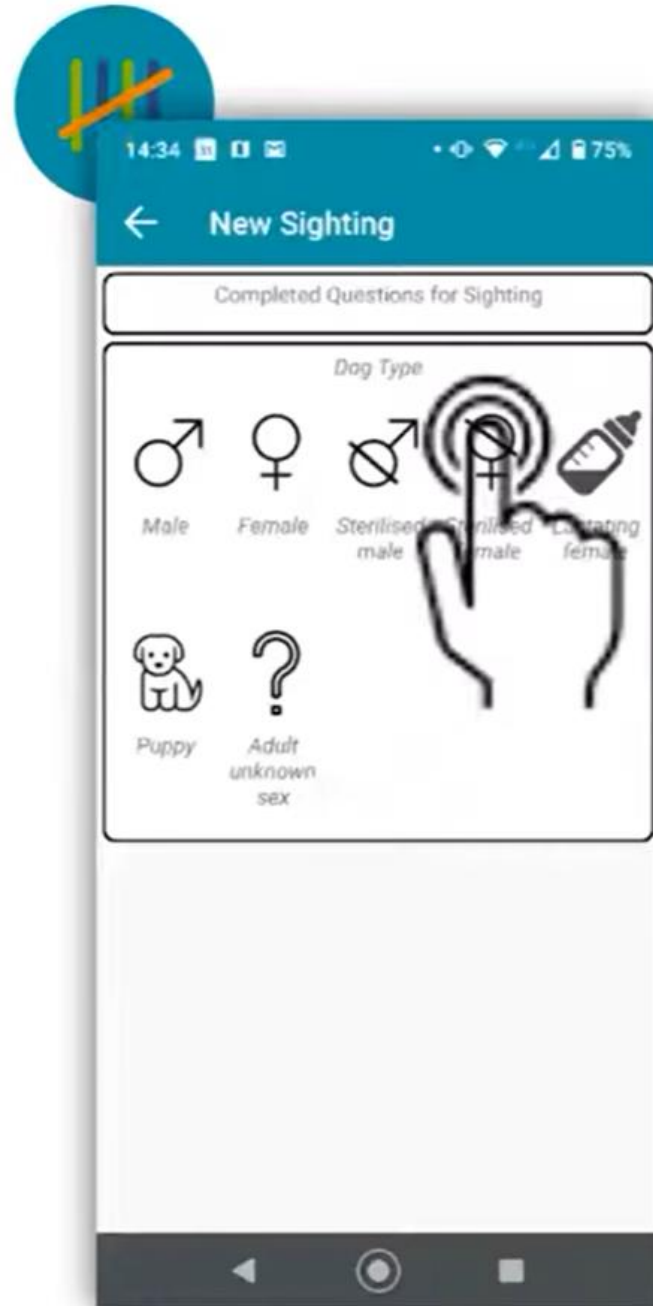

Talea web and app

- Easy
 - Icons
 - Single tap
 - Edit and delete
 - Navigation and 'off route' indication

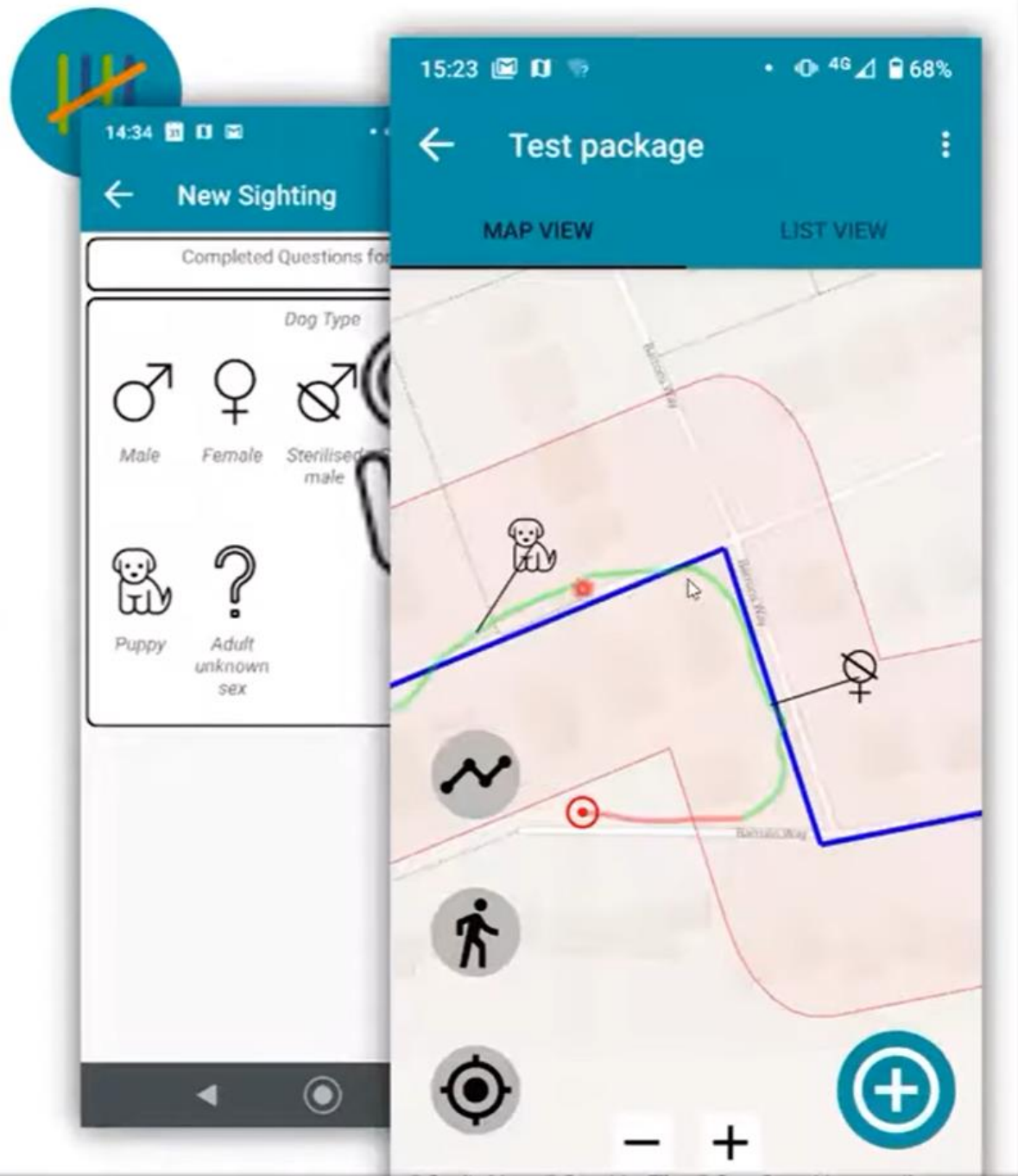

Talea web and app

- Easy
 - Icons
 - Single tap
 - Edit and delete
 - Navigation and 'off route' indication
 - Any language
- Android only, not iOS

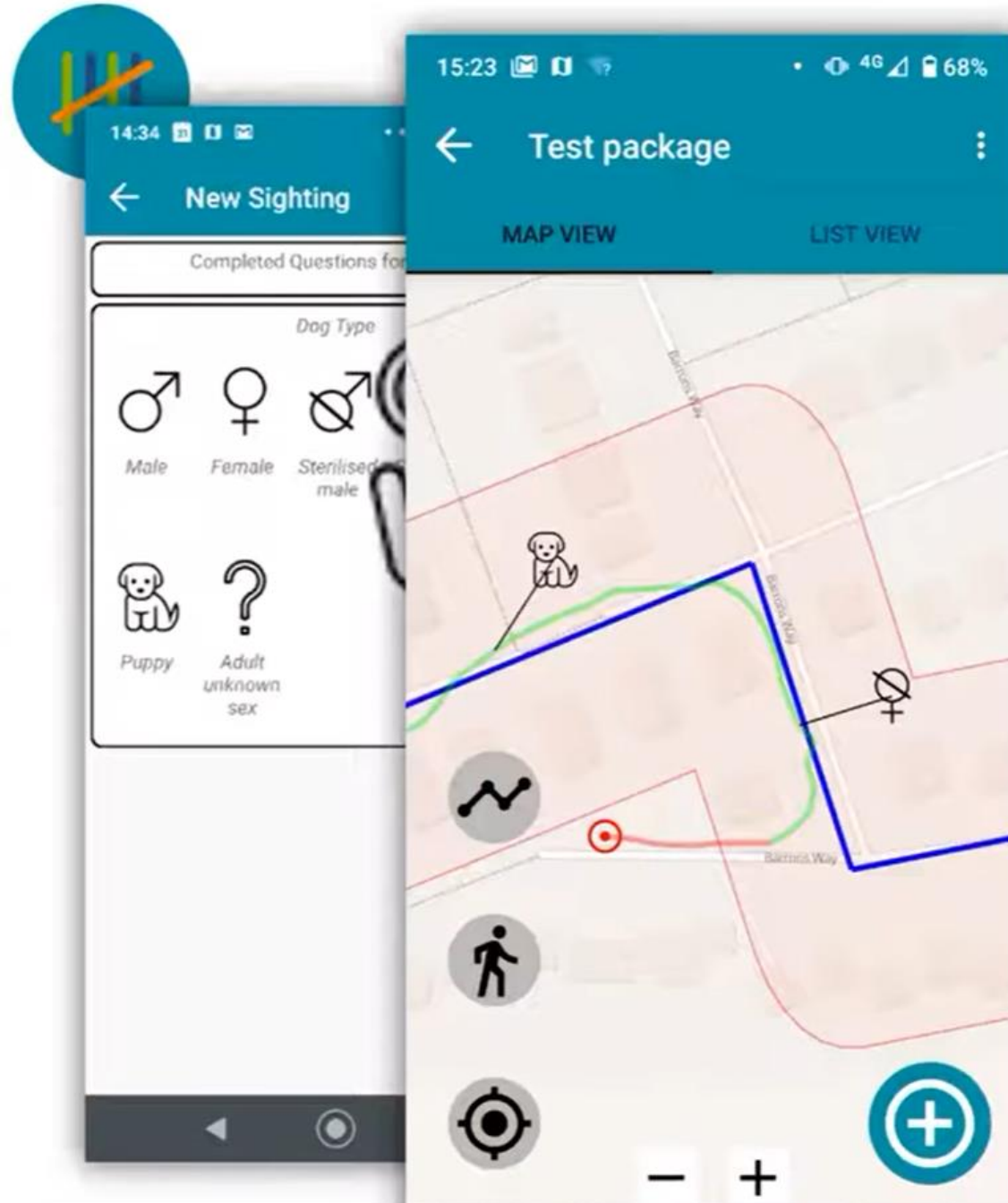



Welcome, Ely Hby (Project Administrator for ICAH Talea Demonstration Project / All Project Areas). Your time zone is Central European Time

Switch role Log out

Portal

Administration

Talea

Talea



Licenses



Groups



Devices



Device Invitations



Icons



Templates



Sandboxes



Studies



Packages



Analysis

App Instructions

Full instructions on how to set-up, install and use Talea are available on our user guide www.icam-coalition.org/talea-user-guide/ - both written and video instructions are available. Please let us know if this guidance is not clear, or if you need extra support, by sending an email message to Talea@icam-coalition.org.

If you would like to send out single user, one-time usage instructions then please use the Device Invitation link above. Use the links below for shareable, multi-use instructions.

Install the Talea app by using this link...

Portal

Administration

Tools

Locales

Templates

App Instructions

Full instructions on how to set-up, install and use the app are available. Please let us know if you have any questions.

Welcome, Ely Hby (P)

Locales

Survey strategies | Locales | Tools App Labels

English, Great Britain (en_GB)	<input checked="" type="checkbox"/>
Al Urdu, Jordan (ar_JO)	<input type="checkbox"/>
English, United States (en_US)	<input type="checkbox"/>
Espanol, Espana (es_ES)	<input checked="" type="checkbox"/>
Espanol, Colombia (es_CO)	<input type="checkbox"/>
Espanol, Ecuador (es_EC)	<input type="checkbox"/>
Hungarian, Hungary (hu_HU)	<input type="checkbox"/>
Georgian, Georgia (ka_GE)	<input type="checkbox"/>
Malaystan, Malaysia (ms_MY)	<input type="checkbox"/>
Portuguese, Portugal (pt_PT)	<input type="checkbox"/>
Portuguese, Brazil (pt_BR)	<input type="checkbox"/>
Portuguese, Cabo Verde (pt_CV)	<input type="checkbox"/>
Russian, Russia (ru_RU)	<input type="checkbox"/>
Sinhala, Sri Lanka (si_LK)	<input type="checkbox"/>
Serbian, Serbia (sr_RS)	<input type="checkbox"/>
Thai, Thailand (th_TH)	<input type="checkbox"/>
Turkish, Turkey (tr_TR)	<input type="checkbox"/>
Ukraina, Ukraine (uk_UK)	<input type="checkbox"/>

<https://www.wise-monkey.org/wisemonkeyportal/p4917p=966> app by using this link...

Portal

Administration

Talea

Locales

Templates

App Instructions

Full instructions on how to set up the app are available. Please refer to the user manual for more information.

If you would like to send out single-use or multi-use instructions, please refer to the user manual for more information.

<https://www.wise-monkey.org/wisemonkeyportal/p496?p=971> app by using this link.

Talea Survey Template Designer

 Name

en_GB Dog survey with sterilisation welfare and ownership

es_ES





Questions

- 1: Dog Type
- 2: Body condition score
- 3: Skin condition
- 4: Sign of ownership
- 5: Is this dog vaccinated?

Summary Values

- 1: Dogs per km
- 2: % sterilised

Choices

Icon	Name	en_GB	es_ES
	Name	en_GB Male	es_ES Macho
	Choice Name	Male	
	Visible Rule		
	Name	en_GB Female	es_ES Hembra
	Choice Name	Female	
	Visible Rule		
	Name	en_GB Sterilised male	es_ES
	Choice Name	Sterilised_M	
	Visible Rule		
	Name	en_GB Sterilised female	es_ES
	Choice Name		
	Visible Rule		

Question Name: Dog_type

Visible Rule:

Required Rule:

Multiple Choice:



- Portal
- Administration
- Talea



Locales



Groups



Templates



Sandboxes

App Instructions

Full instructions on how to set-up, install and use Talea are available or instructions are available. Please let us know if this guidance is not clear.

If you would like to send out single user, one-time usage instructions or multi-use instructions.

Sandboxes

Create New Survey Sandbox

Sandbox name: en_GB: test to send mail

en_GB

en_GB

Distance outside of roads or water that is still valid (m): 15

GP's capture frequency (s): 4

Minimum distance between track points (m): 4

Minimum recording distance between track points (m): 10

Require sighting location selection:

A.K.A.:

Select a Map Type:

* Indicates a required field



- Portal
- Administration
- Talea



Locales



Groups



Templates



Sandboxes

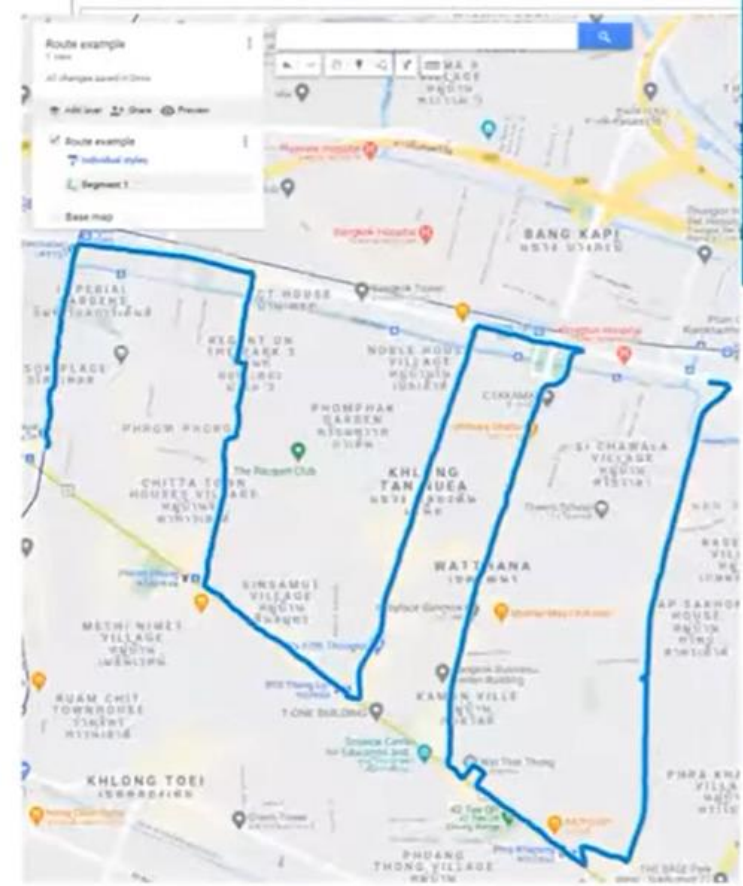

Sandboxes

Create New Survey Sandbox

Sandbox Name:

Distance outside of road or area that is still valid (m):

GPS capture frequency (s):

Maximum distance between track points (m):

Maximum smoothing distance between track points:

Polygon example
2 lines
All changes saved in Disk

Layers:
- Individual styles
- Survey area 1

Base map

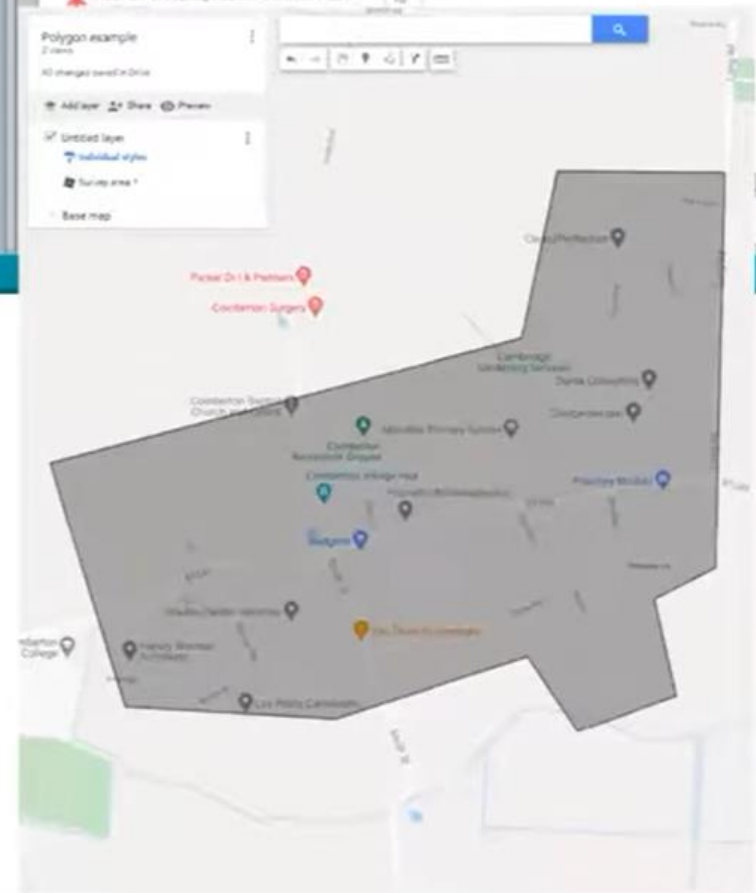



- Portal
- Administration
- Talea

Talea



Locales



Groups



Devices



Device Invitations



Icons



Templates



Studies



Studies



Packages



Analysis



Video
olution.org.

for shareable.

Groups

Showing 1 to 5 of 5

Name	Auto-Assign
Oxford	false
Cardiff	false
Cambridge	true
London	true
Seattle	true

Refresh

Create new Group



- Portal
- Administration
- Talea

Talea

Locales

Groups

Devices

Device Invitations

Icons

Templates

Sandboxes

Studies

Users

Analysts

https://www.wise-mo...

Device Invitations

Create New Device Invitation

* User name: Ely Hby

* Mobile Telephone: +44757121404

* Locale: HK, CA

Multi-Region Support

Cambridge	<input checked="" type="checkbox"/>
London	<input checked="" type="checkbox"/>
Oxford	<input type="checkbox"/>
Cardiff	<input type="checkbox"/>
Seattle	<input checked="" type="checkbox"/>

* Indicates a required field

Cancel Submit

video
coalition.org.

for shareable,

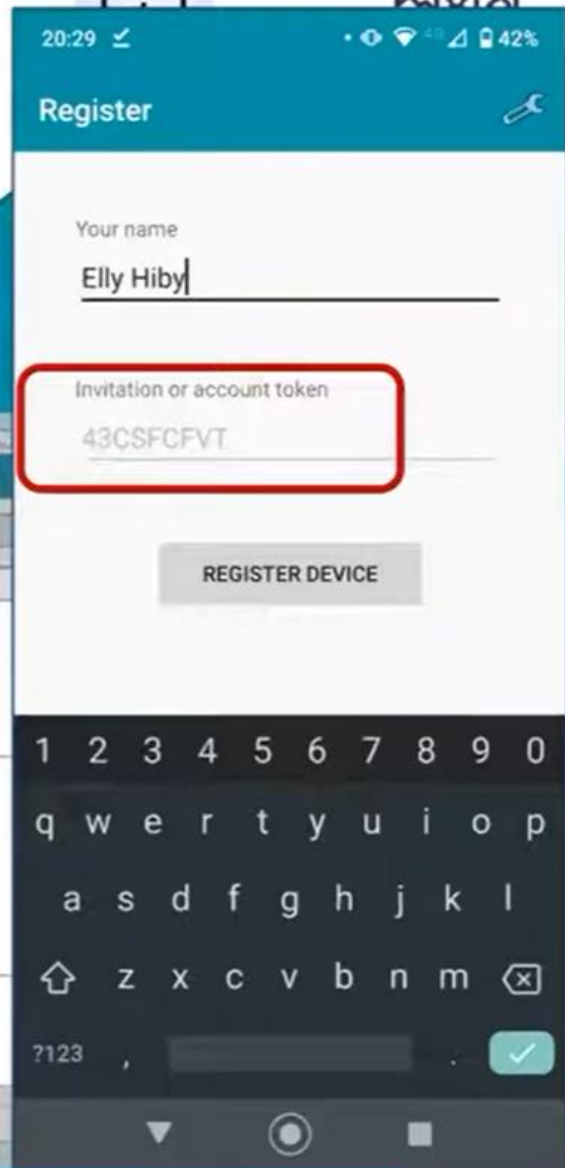
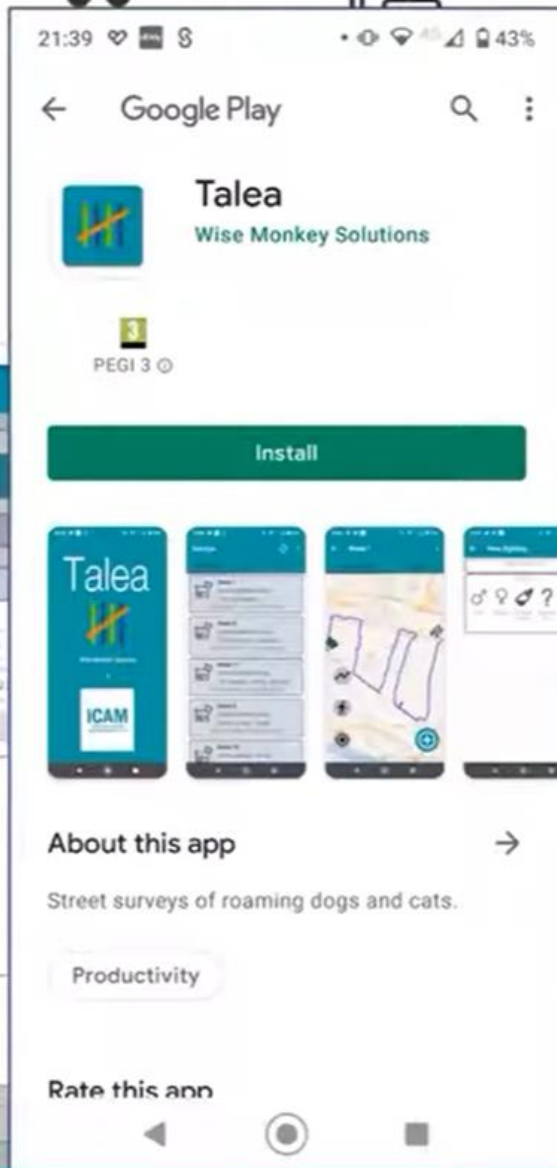



Project





- Portal
- Administration
- Talea**

Talea

- Locales**
- Groups**
- Devices**
- Device Invitations**
- Icons**
- Templates**
- Sandboxes**
- Studies**
- Packages**
- Analysis**

App Instructions

Packages

Create New Survey Package

* Package Name: en_GB East to west Cambridge route
es_ES

* Study: Cambridge survey
Template: Dog survey with sterilisation

* Sandbox: Cambridge survey route

* Start date (must start on or after): 02/03/22 17:15

* End date (must stop on or before): 01/04/22 17:15

Survey can be repeated:

Assigned Groups

Cambridge	<input checked="" type="checkbox"/>
London	<input type="checkbox"/>
Oxford	<input type="checkbox"/>
Cardiff	<input type="checkbox"/>
Seattle	<input type="checkbox"/>

* Indicates a required field

Cancel Save

Project

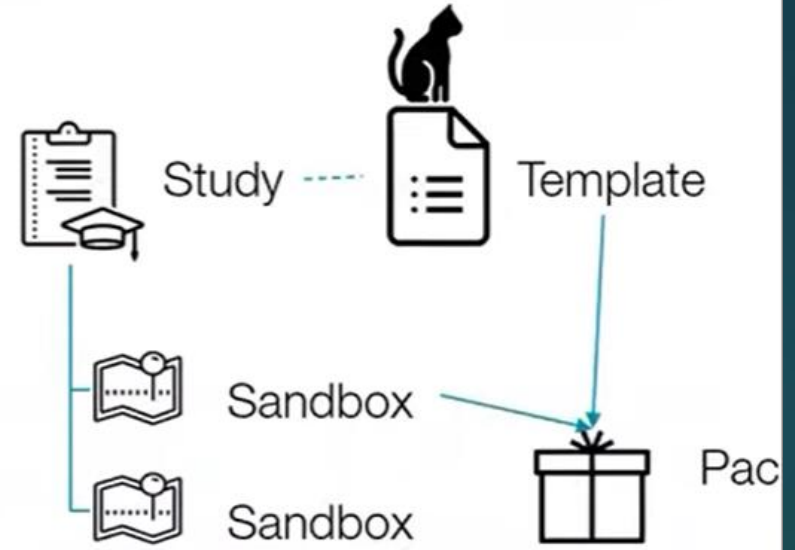
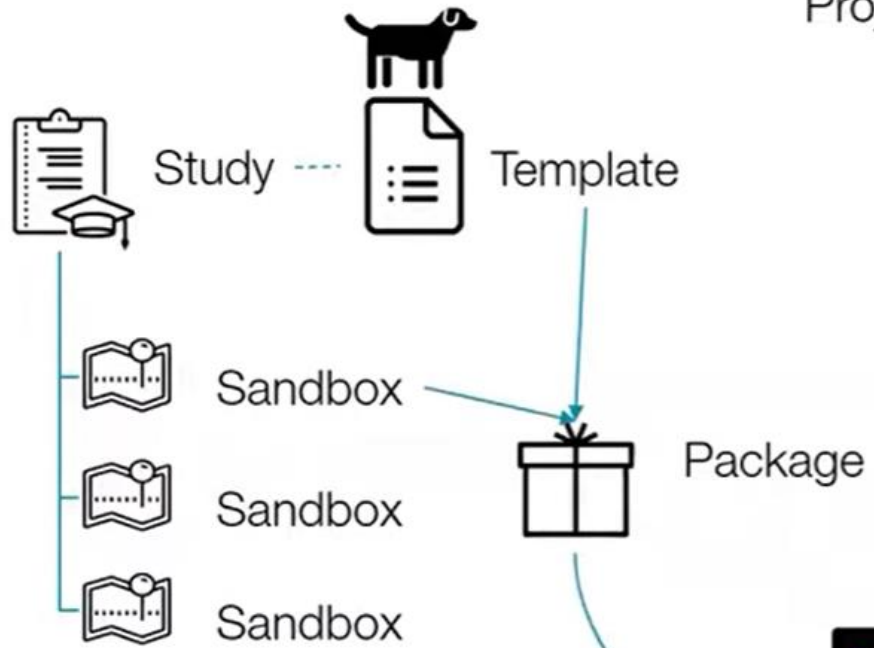

Survey in Route 17





- Portal
- Administration
- Talea

Talea



Localities



Groups



Devices



Device Invitations



Icons



Templates



Sandboxes



Studies



Analysis

Analysis

Analysis

Cambridge demo study

Cambridge 2km lighting

Location

ID: 178

ID: 179

ID: 181

ID: 182

ID: 183

Route to lighting location

Demo day survey

Barnes study

Redwood Day Study

Cambridge survey

West Cambridge day study

Seat for Day Study

Demo study

Survey Details

Start date	13 March 2021 09:41:02 CEST
End date	13 March 2021 09:58:38 CEST
On Route Count (including devices)	23
Lighting Count (including devices)	25
Track Length	2.44km
Track Time	0 hours 17 minutes 12 seconds



Welcome, Ely Hby (Project Administrator for ICAM Talea Demonstration Project / All Project Areas). Your time zone is Central European Time

Switch role Log out

Portal
Administration
Talea

Talea

Lookies
Groups
Devices
Device invitations
Icons
Templates
Sandboxes
Studies
Analysis

Analysis

Cambridge demo study

Survey Details Study Data Download Links

To download study data immediately, click one of the links. To copy the download URL to the clipboard, for use in another application, click the icon to the right of the link.

Location

- Location ID: 126
- Location ID: 179
- Location ID: 181
- Location ID: 182
- Location ID: 183

Route to lighting location

- Demo-log survey
- Berman study
- Redmond Ding Study
- Leedsbridge survey
- West Cambridge study
- Seattle Ding Study
- Demo study

Location

Excel export for study

Zip file of CSV files export for study

KML export for study

KMZ export for study



Talea Quick Start guide



Enter your details on the Talea Sign up page (www.wise-monkey.org/wisemonkeyportal/taleasignup)



Receive an email invitation from WiseMonkey to create a password for your Talea project

Login to Talea web to create your survey package



Locales—If your observers need to use in Talea app in a language other than English, select additional languages here



Template—What your observers should record for each sighting. Select a template from the library or create your own



Icons—If you need new icons for amending or creating a template



Sandbox—Where your observers should survey. Import kml files for routes or polygons



Devices—If you need to change your observer's name, language or group



Groups—Create one or more groups for your observers



Device invitations—Invite your observers to download Talea app and join your project



Studies—Your Study has one Template but surveys can be done in more than one Sandboxes.



Packages—'Wrap up' the Template and Sandbox for sending to Talea app on your observer's device



Talea app—Observers select their survey from the 'Available' tab, follow the route or keep their track within the polygon, add and save sightings, complete the survey and then sync to send the data



Analysis—View the surveys and download your data in different formats

Useful links

<https://www.icam-coalition.org/talea-user-guide/>

<https://www.icam-coalition.org/talea-user-guide/>

ICAM

ABOUT CONFERENCE TOPICS TOOLS DOWNLOADS CONTACT

Talea user guide

ICAM > Talea user guide

Search

1. How does Talea work

2. How to set up your Talea project

- 2.1. How to create a Talea project
- 2.2. How to add survey managers, Administration.
- 2.3. How to select what language your Talea app will use. Locales
- 2.4. How to group your observers. Group
- 2.5. How to invite new observers to your project. Device Invitations
- 2.6. How to change observer name,

Talea is comprised of two components:

1. Talea web: The web-based Project where the survey is created and surveyors are managed
2. Talea app: The mobile phone app where data is collected and submitted to the Project

The project manager is responsible for setting up and managing the Project. The web-based Talea Project must be set-up before observers are invited by the project manager to download the Talea app and collect data. The observers use the app to collect data using the Packages sent by the project manager to the app on their Device. Observers then submit completed surveys to the Project where the project manager can view, analyse and download the data.

<https://www.icam-coalition.org/webinar-talea/>

<https://www.icam-coalition.org/webinar-talea/>

ICAM

ABOUT CONFERENCE TOPICS TOOLS DOWNLOADS CONTACT

Talea street survey tool

Ambitions to survey your roaming dog or cat population? (Or any other species for that matter!) But don't know how to get started or record the data? Learn about ICAM's Talea web and app – our FREE survey tool:

This webinar is an introduction to Talea and examples of its use in the field. Please go to the [user guide](#) for more information on how to use Talea.

- Elly Hiby (ICAM) Introduction to the webinar

ICAM Elly Hiby (ICAM): Talea webinar

Thank you!





RESULT OVERVIEW OF USING WVS APP IN FREE ROAMING DOG SURVEY



Monitoring and Evaluation in CNVR campaigns in BiH

WVS Support

The objective of the dog population evaluation was to assess the size and demographic, have information about dogs, of the free-roaming dog population in key project areas. The outcomes of the survey serve as a benchmark from which to monitor changes in the dog population following the implementation measures to improve dog population management.

Provision of Training in Survey methodology and data analysis



List of Key Players



Government

The government is a key providing resources and support



NGOs

Non-governmental organizations are essential for providing services and advocacy, helping with pushing authorities with initiatives like this survey



Communities

Communities are the primary beneficiaries of CNRV campaigns, and their participation is essential.

These three key players are essential for maximizing outcomes with M&E in CNRV campaigns.

2022

Six municipalities

two days in April,
two days in May,
one day in June

1800 dogs

56 surveys

	Canton	Metric 2	Survey Dates	Total Surveys	Total sightings	Invalid GPS
Federacija BIH	Una Sana Canton	Bihać	12-13 May '22	18	337	11
		Bosanska Krupa	12-13 May '22	10	649	0
		Sanski Most	12-13 May '22	17	392	51
		Ključ	12-13 May '22	6	177	0
	Bosnia Podrinje Kanton	Goražde	9 June '22	3	91	0
Republika Srpska	Bijeljina	Lopare	28-29 April '22	2	154	0
Total				56	1800	62

Timeline of survey

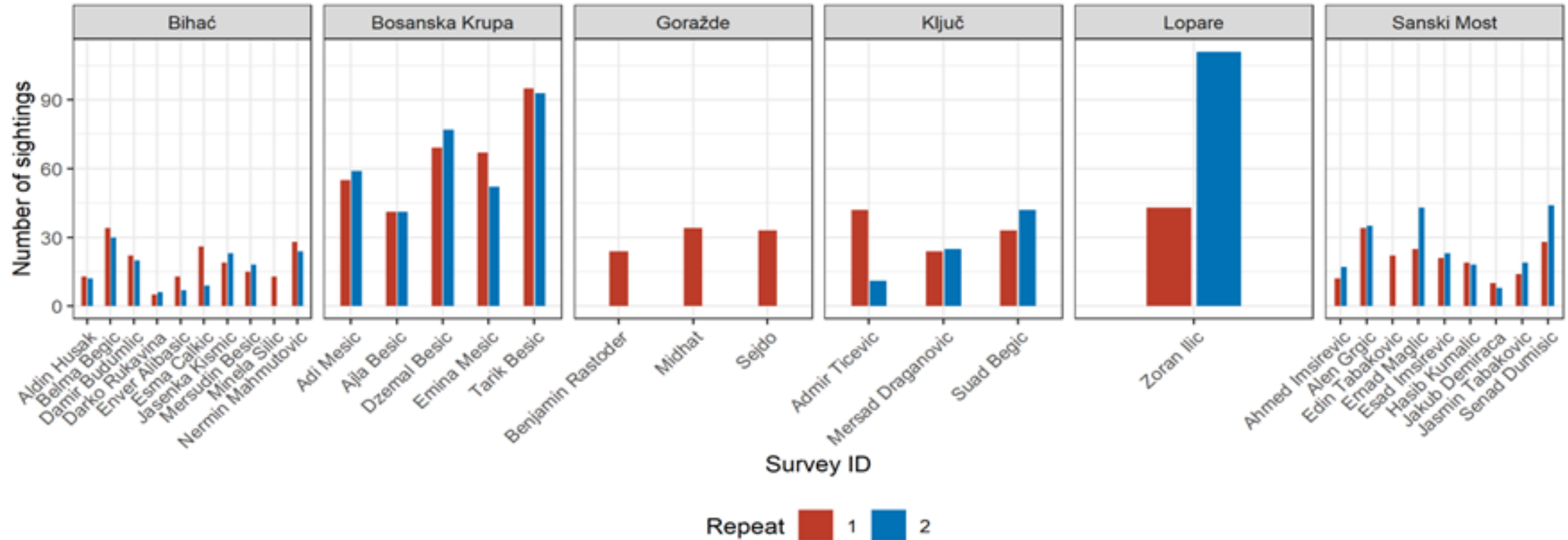
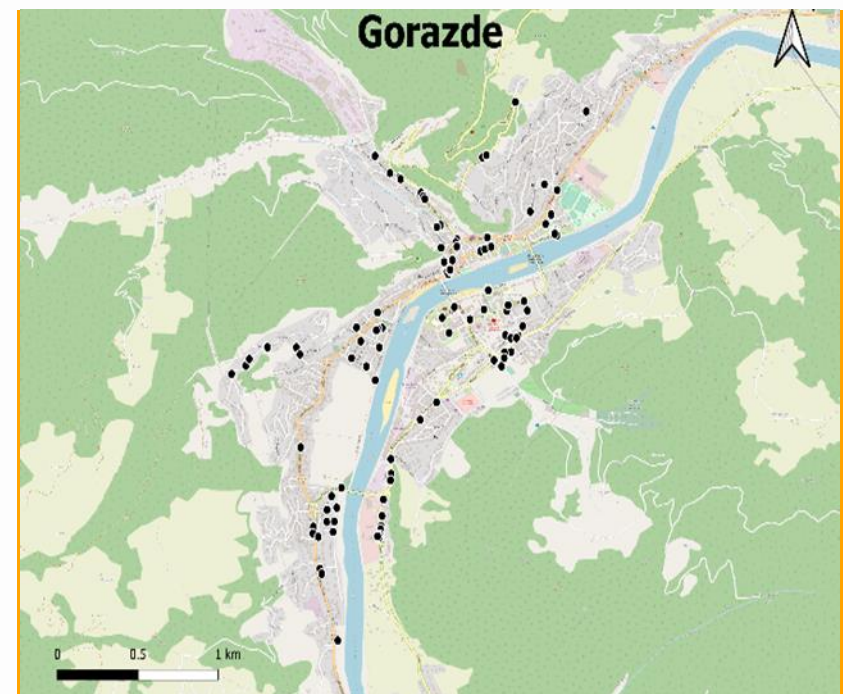
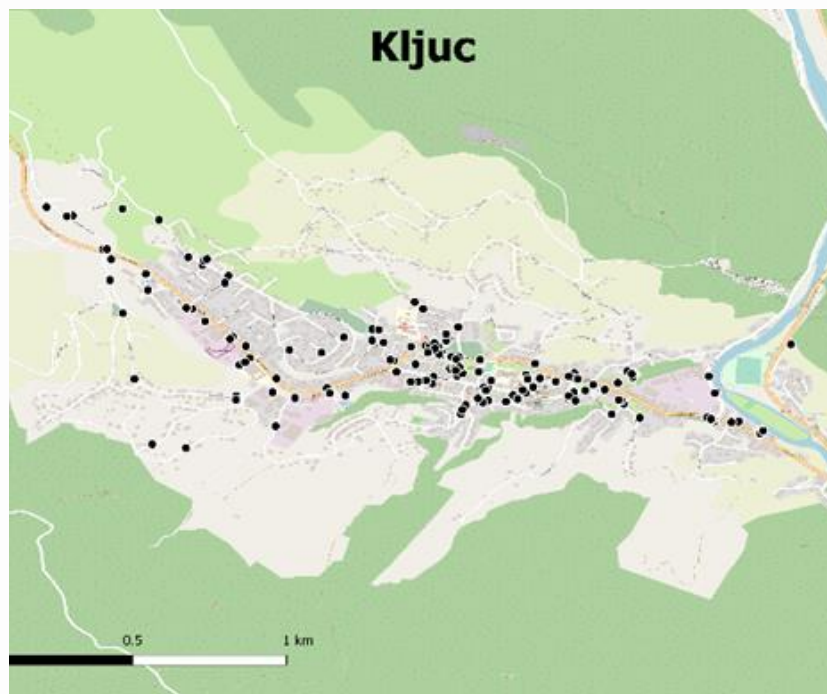
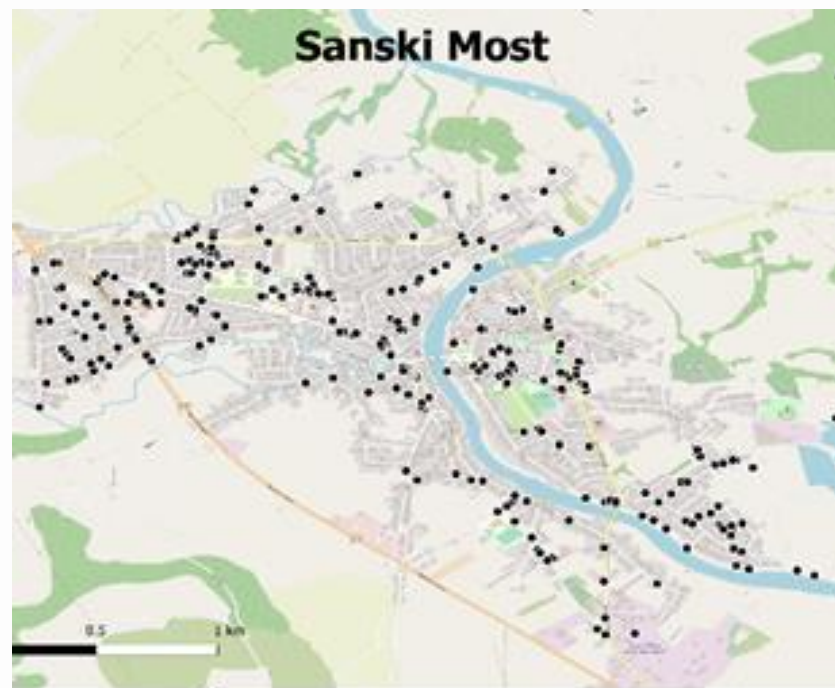
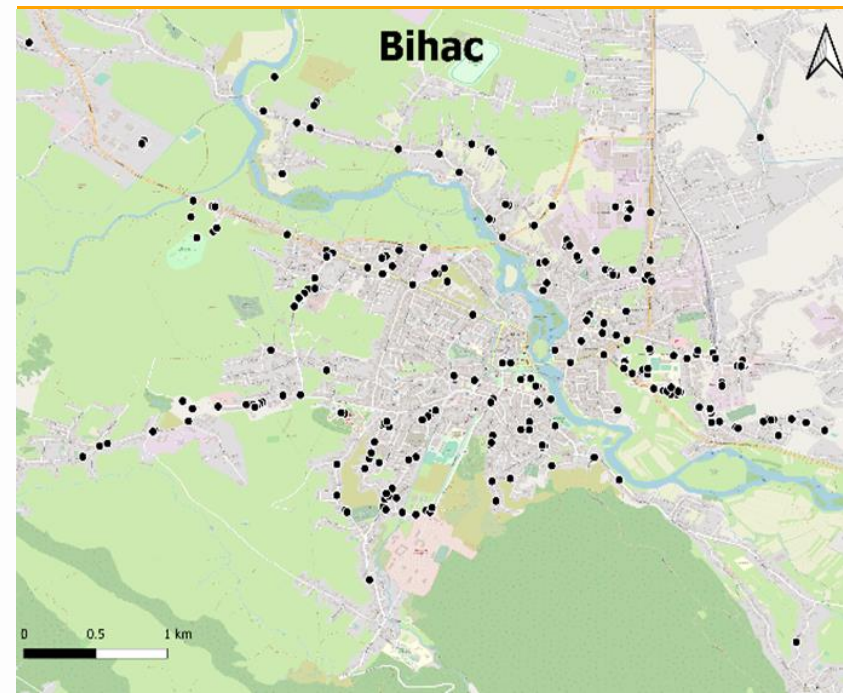
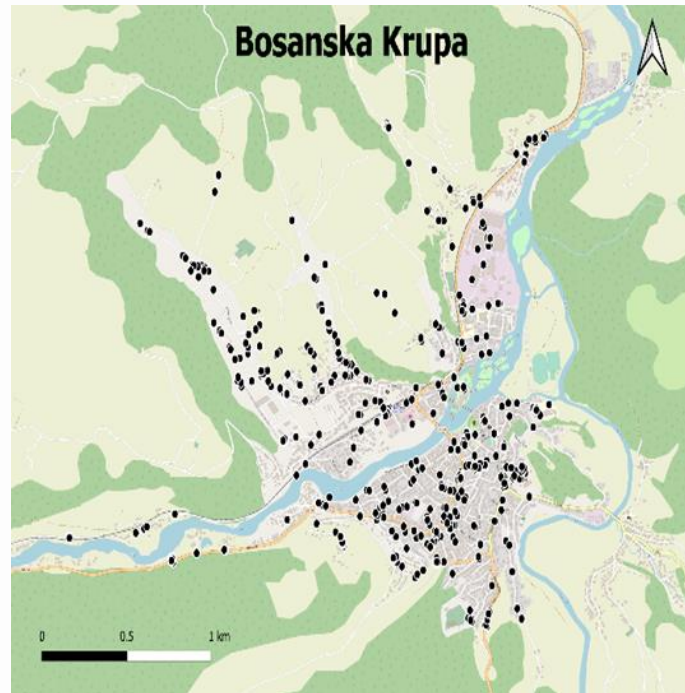
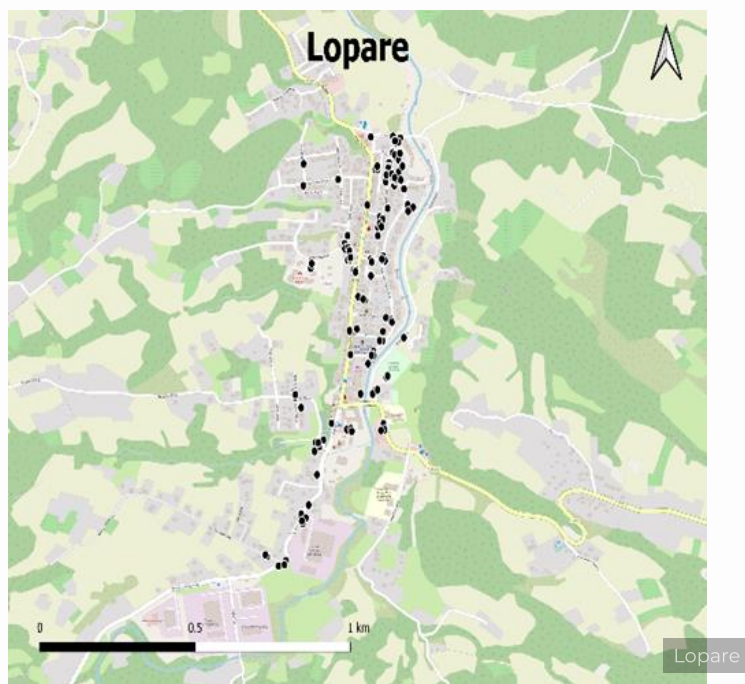

Figure 2 – Dog sightings per survey, by municipality and user. Most surveys were repeated as indicated by a red (first survey) and blue (second survey) bars.



Population Estimate

Dog population estimates in mapped survey zones based on abundance and upper / lower detectability

Location	Mean abundance (dogs / km)	Region road length (km)	Estimated dogs	Detectability y 0.6	Detectability y 0.4
Bihać	4.2	173.7	736	1227	1840
Bosanska Krupa	8.8	60.7	531	886	1328
Goražde	5.9	89.5	531	884	1326
Sanski Most	7.4	67.1	499	832	1248
Ključ	7.9	19.4	153	255	382
Lopare	14.4	10.2	147	245	367

**“Measuring outcomes is the key to
maximizing them.”**

Charting Data from the app that were entered in forms

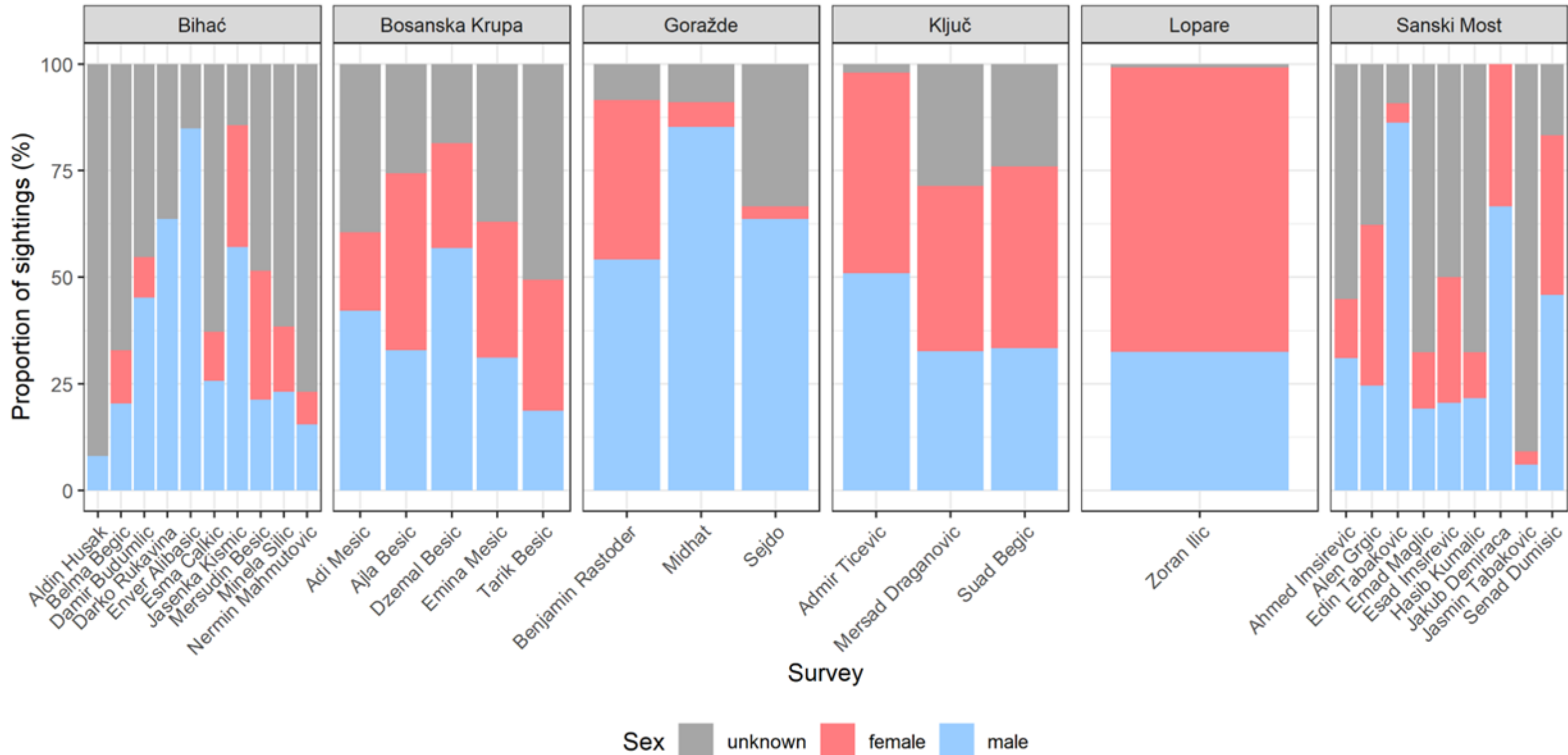

Why is it important?

To inform the public, people from municipalities, and DTW of the impacts of the intervention

To compare interventions and their relative impacts, and plan future ones

We are lucky to have cooperation with WVS who trained and help us

This tool is available as Thalea app, each is user friendly and can provide training

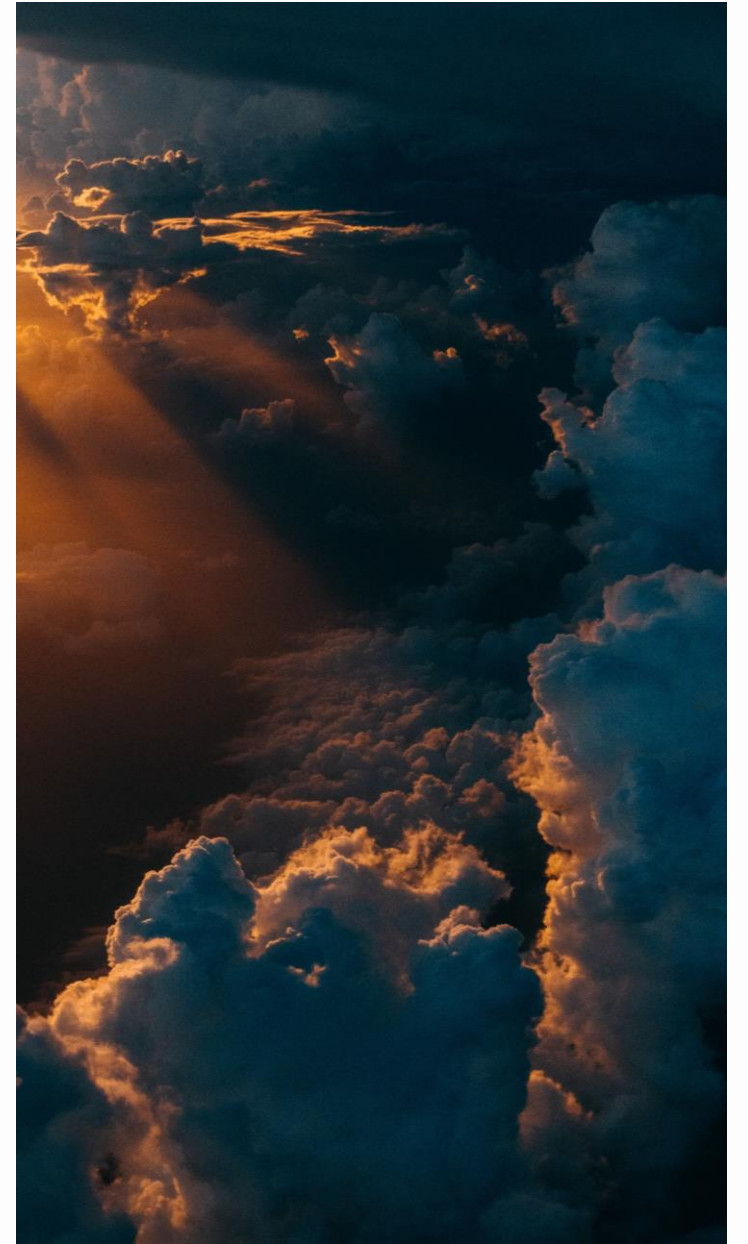

How did we do it?



Municipalities and cities

Colaborate and ask for support



Who are those people taking photos of dogs and walking with their phones at 5 am?

Volounteers, can be NGO, local vets, veterinarians,vet students



Organisation

One person who is coordinating (person in charge) with desktop version and access to internet, and people who are doing surveys dont need internet just phone and app

By strengthening the data collection processes, CNRV campaigns can maximize outcomes, but also other DPM interventions

Preparing Staff for the First Day: Planning and Training for Success

Planning ahead is essential for any successful project. Training staff on the first day ensures that everyone is on the same page and knows what their responsibilities are.

First coordinator must be trained or go through the app and make routes and users ID s and after train also all the users who are going to conduct the survey



DOGS TRUST BOSNIA PROGRAMS:

1. CNVR
2. VTP
3. DOG SCHOOL
4. FOSTERING
5. EDUCATIONAL WORKSHOPS OF CHILDREN
6. PUBLIC EVENTS AND PROVIDING PUBLIC EDUCATION ON RESPONSABLE OWNERSHIP

101,950

OBRADENIH
PASA



1144

PASA
OBUČENO
U ŠKOLI
ZA PSE



50

UDOMLJENIH
SPASENIH
PASA



108

medijskih
kampanja



51

organizovanih
događaja + 10
webinara



2495

saopćenja za javnost

- From 2022 we changed a bit approach to CNVR Programme deciding to work more with local communities
- In 2022 a part of DPM training in Skopje were as one of the s the importance of monitoring and evaluation
- Implementing DPM (ICAM learning) great tool for different stakeholders
- Thalea and WVS app easy and free tools that can help estimate success of different DPM interventions that are in DPM action plans

Thank you for your attention!



Dinarević Anida, DVM

E-mail:

anida.dinarevic@dogstrust.ba